

GRADING LEGEND DC EXHIBIT F

	PROPERTY LINE
	EXISTING EASEMENT
	PROPOSED CONTOUR
	EXISTING CONTOUR
	RIDGE LINE
	FLOWLINE
	PROPOSED STORM DRAIN
	FINISH GRADE
	PROPOSED SLOPE
	GRADE BREAK

NOTE
 1. FOR CROSS SECTION VIEWS FOR A-A, B-B, C-C, AND D-D REFER TO SHEET C10.0.

STORM DRAIN NOTES	
KEYNOTE	NOTE DESCRIPTION
1	PROPOSED GRATING 18"x18" CATCH BASIN PER SPPWC 305-3.
2	PROPOSED HDPE STORM DRAIN LINE. SIZE PER PLAN. TRENCHING PER CITY OF ROSEVILLE STANDARD DETAIL TB-2, SHEET C10.0.
3	TIE INTO EXISTING STORM DRAIN LINE STUB.
4	PROPOSED CURB OPENING BIOCLEAN MODULAR WETLAND MWS-L-4-4-C.
5	PROPOSED 12" X 12" AREA DRAIN.
6	CONNECT PROPOSED ROOF DRAIN INTO UNDERGROUND SD SYSTEM.
7	PROPOSED FLARED END SECTION OUTLET WITH OUTLET PROTECTION.

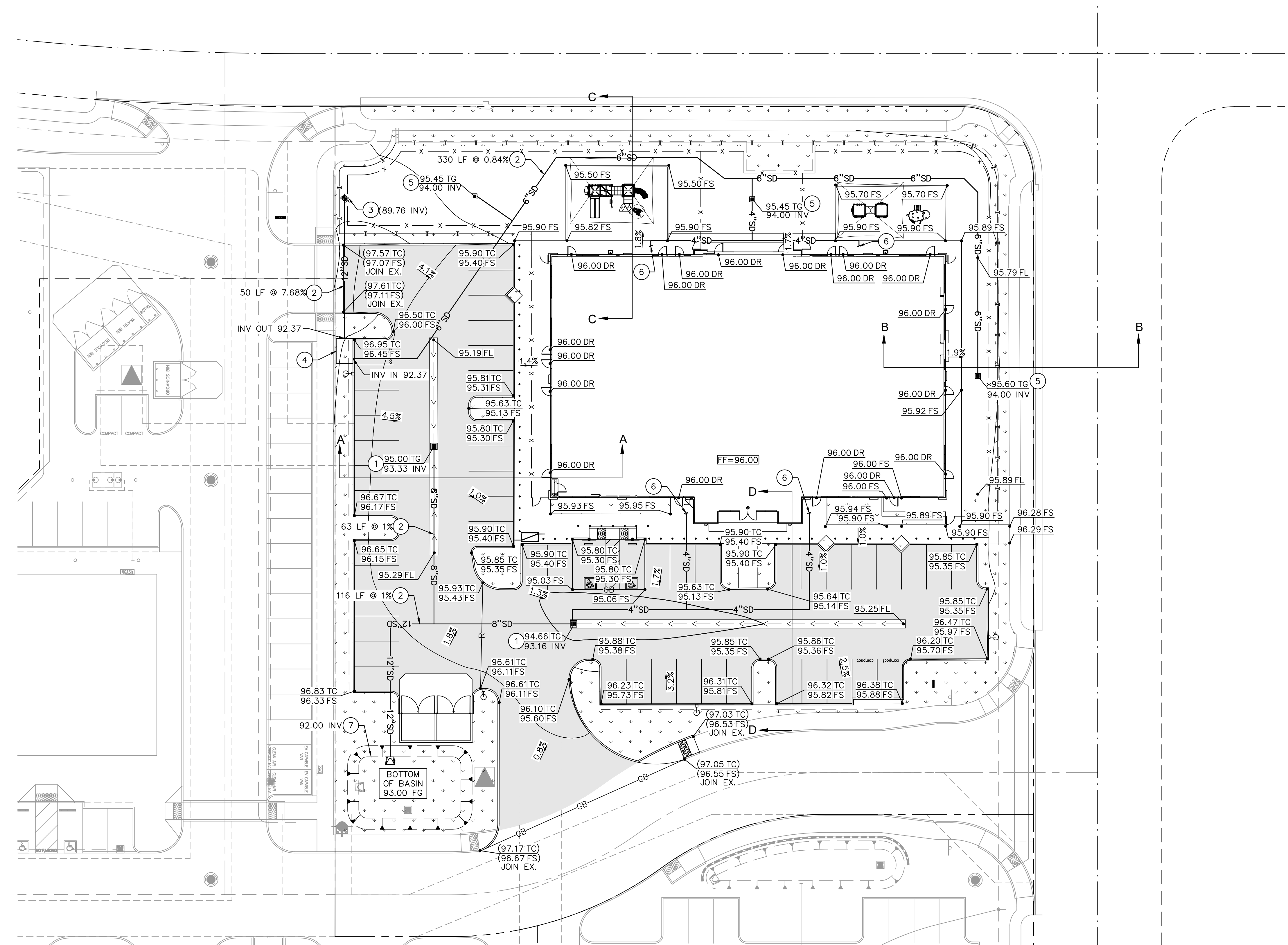

Plotted By: Francisco, Francisco - Sheet Set: Kha - Layout: C9.0 GRADING PLAN - January 26, 2022 - 01:46:26pm - \\kimley-horn.com\CA_ORA\ORA_LDEV\AHC2\ROSEVILLE\CAD\PlanSheets\CONSTRUCTION_DOCUMENTS\C9.0 GRADING PLAN.dwg
 This document, together with the concepts and designs presented herein, is intended only for the specific purpose and client for which it was prepared. Release of any information or design contained herein without written authorization and signature by Kimley-Horn and Associates, Inc. shall be without liability to Kimley-Horn and Associates, Inc.



No.	REVISIONS	DATE	BY

Kimley»Horn
 © 2022 KIMLEY-HORN AND ASSOCIATES, INC.
 1100 W TOWN AND COUNTRY ROAD, SUITE 700,
 ORANGE, CA 92668
 PHONE: 714-939-1030 FAX: 714-938-9488
 WWW.KIMLEY-HORN.COM

KHA PROJECT
 194378001
 DATE
 1/26/22
 SCALE AS SHOWN
 DESIGNED BY RWA
 DRAWN BY RWA
 CHECKED BY JSG

GODDARD SCHOOL
 2801 OAK MEADOW DR
 PLAZA AT BLUE OAKS
 ROSEVILLE CA

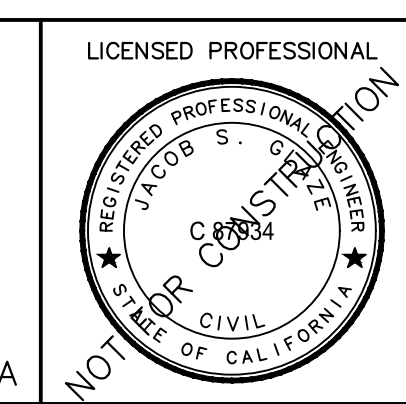

CITY OF ROSEVILLE
 DEPT. OF DEVELOPMENT SERVICES

ACCEPTED BY: _____

CIVIL ENGINEER DATE

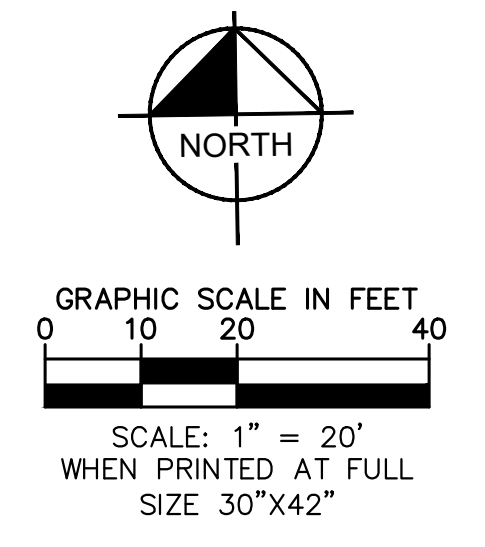

GRADING PLAN

SHEET NUMBER
C7.0

Plotted By: Francisco, Francisco_Sheet Set: Kthb Layout: C10.0 CROSS SECTIONS January 26, 2022 01:46:53pm \\kimley-horn.com\CA_ORA_LDEV\AKC2\ROSEVILLE\CAD\PlanSheets\CONSTRUCTION DOCUMENTS\C8.0 GRADING PLAN.dwg

This document, together with the concepts and designs presented herein, is intended only for the specific purpose and client for which it was prepared. Release of and improper reliance on this document without written authorization and approval by Kimley-Horn and Associates, Inc. shall be without liability to Kimley-Horn and Associates, Inc.



No.	REVISIONS	DATE	BY

Kimley»Horn
 © 2022 KIMLEY-HORN AND ASSOCIATES, INC.
 1100 W TOWN AND COUNTRY ROAD, SUITE 700,
 ORANGE, CA 92668
 PHONE: 714-939-1030 FAX: 714-938-9488
 WWW.KIMLEY-HORN.COM

KHA PROJECT 194378001
DATE 1/26/22
SCALE AS SHOWN
DESIGNED BY RWA
DRAWN BY RWA
CHECKED BY JSG

GODDARD SCHOOL
 2801 OAK MEADOW DR
 PLAZA AT BLUE OAKS

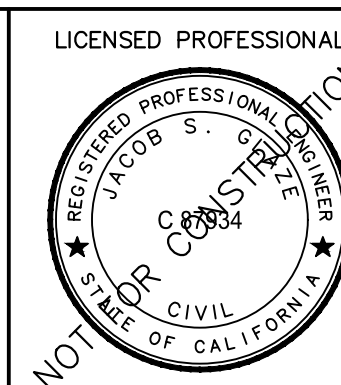

CITY OF ROSEVILLE
 DEPT. OF DEVELOPMENT SERVICES
 ACCEPTED BY: _____
 CIVIL ENGINEER DATE

CROSS SECTIONS

SHEET NUMBER
 C8.0

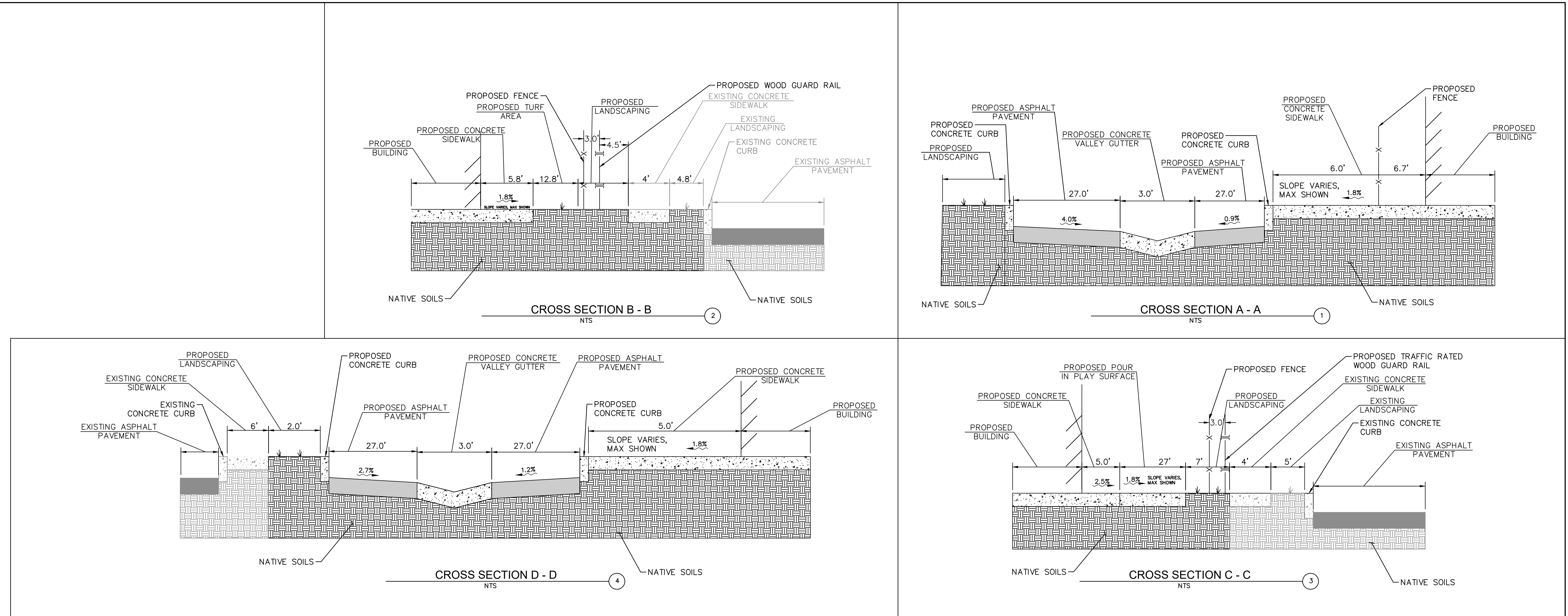

SITE SPECIFIC DATA	
PROJECT NUMBER	
ORDER NUMBER	
PROJECT NAME	
PROJECT LOCATION	
STRUCTURE ID	
TREATMENT REQUIRED	FLOW BASED (CFS)
VOLUME BASED (CFS)	
TREATMENT FLOW AVAILABLE (FT)	
PEAK BYPASS REQUIRED (CFS) - IF APPLICABLE	
PIPE DATA	I.E. MATERIAL DIAMETER
INLET PIPE 1	
INLET PIPE 2	
OUTLET PIPE	
PRETREATMENT	BIOFILTRATION DISCHARGE
RIM ELEVATION	
SURFACE LOAD	PEDESTRIAN OPEN PLANTER PEDESTRIAN
FRAME & COVER	24" x 42" N/A
WETLAND MEDIA VOLUME (CY)	TBD
GRIPSE SIZE (GRA INCHES)	TBD

- INSTALLATION NOTES**
- CONTRACTOR TO PROVIDE ALL LABOR, EQUIPMENT, MATERIALS AND ACCESSORIES REQUIRED TO OBTAIN AND INSTALL THE SYSTEM AND APPEARANCES IN ACCORDANCE WITH THIS DRAWING AND THE MANUFACTURER'S SPECIFICATIONS, UNLESS OTHERWISE STATED BY MANUFACTURER'S CONTRACT.
 - UNIT MUST BE INSTALLED ON LEVEL BASE. MANUFACTURER RECOMMENDS A MINIMUM 6" LEVEL ROCK BASE UNLESS SPECIFIED BY THE PROJECT ENGINEER. CONTRACTOR IS RESPONSIBLE TO VERIFY PROJECT ENGINEER'S RECOMMENDED BASE SPECIFICATIONS.
 - ALL PIPES MUST BE FLUSH WITH INSIDE SURFACE OF CONCRETE (PIPES CANNOT INTERSECT BEYOND FLUSH). INVERT OF OUTFLOW PIPE MUST BE FLUSH WITH DISCHARGE CHAMBER FLOOR. ALL GAPS AROUND PIPES SHALL BE SEALED WITH A NON-SINKING GROUT PER MANUFACTURER'S STANDARD CONNECTION DETAIL AND SHALL MEET OR EXCEED REGIONAL PIPE CONNECTION STANDARDS.
 - CONTRACTOR TO SUPPLY AND INSTALL ALL EXTERNAL CONNECTING PIPES.
 - CONTRACTOR RESPONSIBLE FOR INSTALLATION OF ALL RISERS, MANHOLES AND HATCHES. CONTRACTOR TO PROVIDE ALL MANHOLES AND HATCHES TO MATCH FINISHED SURFACE UNLESS SPECIFIED OTHERWISE. GROP OR OTHER INSULATION REQUIRED BY ALL UNITS WITH RECESSED.
 - CONTRACTOR RESPONSIBLE FOR CONTACTING MODULAR WETLANDS FOR ACTIVATION OF UNIT. MANUFACTURER'S WARRANTY IS VOID WITH OUT PROPER ACTIVATION BY A MODULAR WETLANDS REPRESENTATIVE.
- GENERAL NOTES**
- MANUFACTURER TO PROVIDE ALL MATERIALS UNLESS OTHERWISE NOTED.
 - ALL DIMENSIONS, ELEVATIONS, SPECIFICATIONS AND CAPACITIES ARE SUBJECT TO CHANGE. FOR PROJECT SPECIFIC DIMENSIONS DETAILING EXACT DIMENSIONS, WEIGHTS AND ACCESSORIES PLEASE CONTACT MANUFACTURER.

